



CR 100 LADDER

2.5 TO 1
STRUCTURAL SAFETY FACTOR

800 LB
LADDER RATING

24"
FLY SECTION WIDTH

300-500
GALLON WATER TANK

As the innovator of aluminum aerials, E-ONE offers a proven track record in aerial safety with ZERO structural failures or tip-overs in more than 30 years of aerial production.



STRENGTH. STABILITY. SAFETY.

If tip-load and low-angle performance top your list of “must haves,” our CR 100 with an impressive 800-lbs. capacity for firefighters is your aerial. It utilizes our famous integral torque box chassis and narrow stabilizer spread to make your job easier while holding heavier loads.

The exclusive integral torque box chassis features a Resistance to Bending Moment (RBM) rating of 14,350,000. The all-welded, structural steel torque box frame with internal gussets relieves ladder stress loads more efficiently without passing undue stresses into the apparatus body and cab. Underslung jack assemblies below the torque box with the high-strength, lightweight aluminum aerial provides a low center of gravity for improved road handling.

CR 100 LADDER

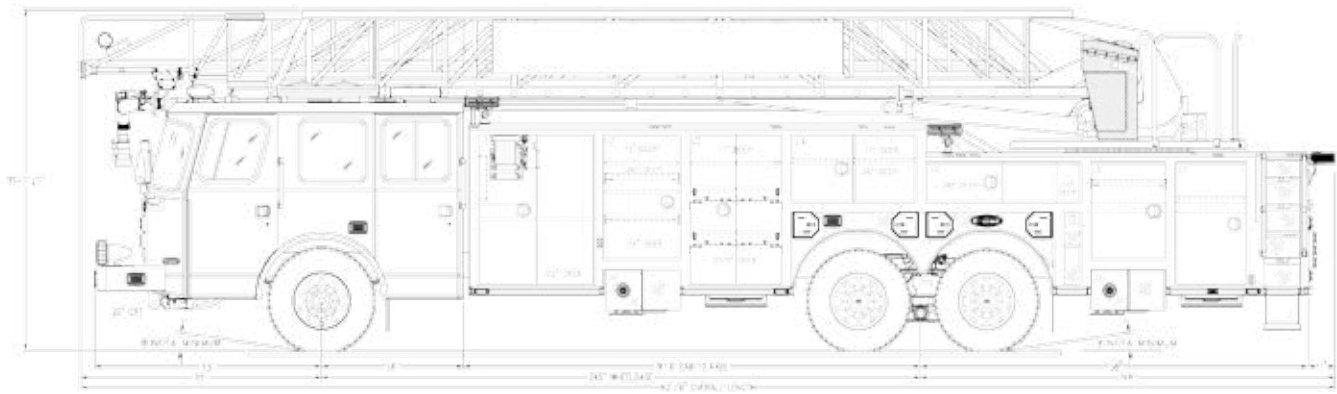

CUSTOM CHASSIS

- Quest® or Cyclone® II chassis
- Medium, long and extended length 4-door cabs available
- Optional split-raised roof
- Integral torque box chassis
- 245-250" wheelbase
- 500-600 HP Engine
- Standard safety features such as roll cage cab, CrewGuard, ABS brakes and G4
- Airbags optional

AERIAL FEATURES

- 100' welded extruded aluminum ladder with 2.5 to 1 structural safety factor
- 800 lb tip load (750-lbs. firefighters and 50-lbs. equipment) dry and 550-lb (500-lbs. firefighters and 50-lbs. equipment) wet
- Criss-cross underslung jacks with only 13' 8" spread
- 11'10" overall height; 12'1" with center hosebed
- 3" lower overall height available with CII aerial cab
- Over 24" fly section width permits stokes basket to fit between handrails
- Options include Aerial Information System (AIS), pinned waterway, 2.5" valve at tip, and ladder, axe and pike pole brackets

BODY CONSTRUCTION

- Body available in aluminum or stainless steel
- Available in center hosebed, SideStacker and truck company configuration
- Sidestacker body features full-depth compartments
- Sidestacker body configuration allows for a full ISO requirement of 182' of ground ladders with a 300 gallon tank

FIRE PACKAGE

- Hale® or Waterous® pumps up to 2000 GPM
- 300-500 gallon water tank
- Stainless steel discharge manifolds
- Optional foam systems, direct injection, CAFS and around the pump (ATP)
- Customizable discharges and preconnects to meet departments needs

ELECTRICAL

- Multiplex electrical system with color display provides increased feature capability and improved diagnostics
- Whelen® optical and audible warning packages standard, others optional
- Options include LED scene lights, LED ladder climbing lights and 6-20 kW hydraulic generators



CONTACT US AT **E-ONE.COM**
OR CALL **352-237-1122** FOR A DEALER NEAR YOU.