



WE INNOVATE EVERY DAY.
e-one.com

NON-WALK-IN RESCUE



SPECIFICATIONS

The E-ONE Non Walk-In Rescue allows first responders to arrive on the scene prepared. Whether responding to a natural disaster or homeland security threat, this Non Walk-In Rescue stores everything from generators to scene lighting and can be outfitted with the latest communications technology. The E-ONE Non Walk-In ensures all necessary gear is stored neatly with optional rooftop compartments, under-body compartments and a recessed pan.

E-ONE engineers custom extruded aluminum and stainless steel products that meet or exceed NFPA standards to protect individuals risking their lives to serve those in need. And by offering our Non Walk-In on one of three of the industry's strongest custom chassis, E-ONE meets first responders' critical needs without sacrificing safety or quality. Respond with more than a tool box on wheels - the E-ONE Non Walk-In Rescue.

OUR VEHICLES CONNECT AND PROTECT
PEOPLE AROUND THE WORLD EVERY DAY.
www.revgroup.com



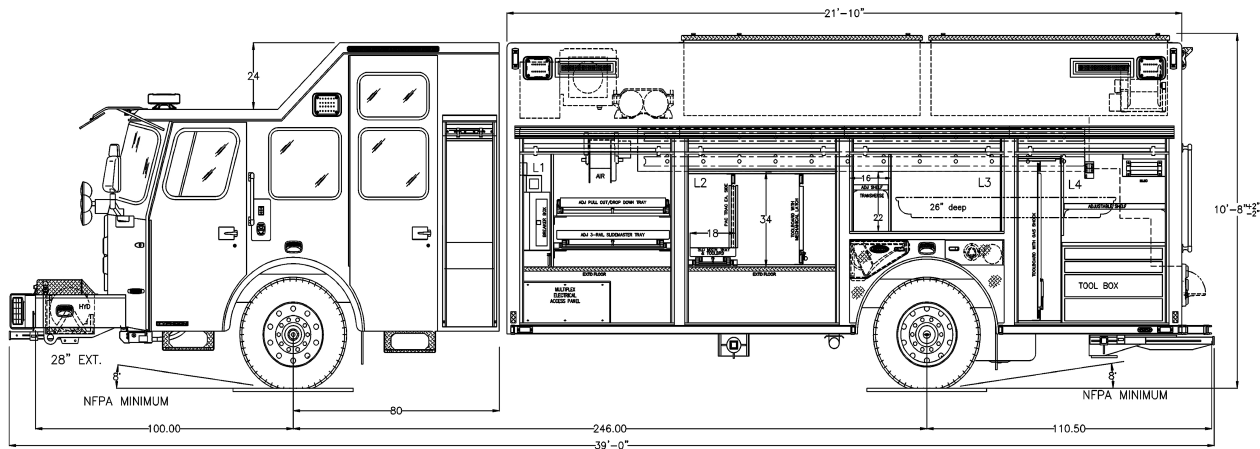

CHASSIS

- The Quest®, Cyclone® II or Typhoon® chassis
- Medium, long and extended length 4-door cabs available
- Heavy duty 12" C-channel frame
- Up to 600 HP Engine
- Standard safety features such as roll cage cab, CrewGuard & ABS brakes
- Optional safety features such as airbags & G4 (electronic stability control)

BODY

- Body available in extruded aluminum or stainless steel
- Body sizes ranging from 16' to 26'
- Exterior access to storage compartments
- Roll up or hinged doors
- Under body compartments
- Awning: electric or manual
- Receivers designed for electric winch or rope rescues

EXTERIOR

- Multiple body configurations available including popular options such as rooftop compartments with center walkway and front storage pan, hydraulic system compartments, slide-out tool boards, air system compartments to store fill station, air reels, air packs and hoses
- Upper body access options: built-in staircase, officer-side ladder, pulldown staircase, or officer's side staircase
- LED, halogen, or fluorescent lighting

RESCUE

- 250-750 GPM pump
- 200-500 gallon water tank
- Foam systems available
- Custom E-ONE PTO driven HRT system. 3, 4 or 6 tools systems
- Compatible with most hydraulic rescue tools
- Breathing air systems: compressors, fill stations, air bottles/cascade system
- Generators: 5kW to 75kW, direct drive, hydraulic, diesel

ELECTRICAL

- Multiplex electrical system with color display provides increased feature capability and improved diagnostics
- Light tower on top of cab or body
- Whelen® optical and audible warning packages standard, others optiona